

RF/RFS & RL/RLS

CLASS H



TRADITIONAL PROTECTION FOR CIRCUITS WITH LESS THAN 10,000A SHORT CIRCUIT CURRENT

RF and RFS general purpose fuses are suitable for application where available short circuit currents do not exceed 10,000 amperes. RF and RFS renewable fuses use matched RL and RLS die-cut zinc links from 1 to 600 amperes in 32 ratings.

Features/Benefits

- **Knurled bushings** for ease of disassembly
- **Rugged construction** for maximum service life
- **Precision die-cut renewal links** renew quickly and give repeatable performance

HIGHLIGHTS:

- Renewable
- 32 Renewal Link Ratings

APPLICATIONS:

- General purpose loads where short circuits are 10,000 amperes or less

Ratings

- **RF**
AC: 1 to 600A
250VAC, 10kA I.R.
- **RFS**
AC: 1 to 600A
600VAC, 10kA I.R.

Approvals

- UL Listed to Standard 248-7 File E2137
- CSA Certified to Standard C22.2 No. 248.7



RENEWABLE CLASS H FUSES/LINKS

RF/RFS & RL/RLS

Standard Fuse Ampere Ratings, Catalog Numbers

Ampere Rating	Catalog Number		Ampere Rating	Catalog Number		Ampere Rating	Catalog Number	
	250V	600V		250V	600V		250V	600V
1	RF1/RL1	RFS1/RLS1	45	RF45/RL45	RFS45/RLS45	225	RF225/RL225	RFS225/RLS225
2	RF2/RL2	RFS2/RLS2	50	RF50/RL50	RFS50/RLS50	250	RF250/RL250	RFS250/RLS250
3	RF3/RL3	RFS3/RLS3	60	RF60/RL60	RFS60/RLS60	300	RF300/RL300	RFS300/RLS300
5	RF5/RL5	RFS5/RLS5	70	RF70/RL70	RFS70/RLS70	350	RF350/RL350	RFS350/RLS350
6	RF6/RL6	RFS6/RLS6	80	RF80/RL80	RFS80/RLS80	400	RF400/RL400	RFS400/RLS400
10	RF10/RL10	RFS10/RLS10	90	RF90/RL90	RFS90/RLS90	450	RF450/RL450	RFS450/RLS450
15	RF15/RL15	RFS15/RLS15	100	RF100/RL100	RFS100/RLS100	500	RF500/RL500	RFS500/RLS500
20	RF20/RL20	RFS20/RLS20	110	RF110/RL110	RFS110/RLS110	600	RF600/RL600	RFS600/RLS600
25	RF25/RL25	RFS25/RLS25	125	RF125/RL125	RFS125/RLS125			
30	RF30/RL30	RFS30/RLS30	150	RF150/RL150	RFS150/RLS150			
35	RF35/RL35	RFS35/RLS35	175	RF175/RL175	RFS175/RLS175			
40	RF40/RL40	RFS40/RLS40	200	RF200/RL200	RFS200/RLS200			

B

Recommended Fuse Blocks With Box Connectors For Renewable Class H Fuses

Fuse Ampere Rating	Catalog Number			
	250V		600V	
	1 Pole	3 pole	1 pole	3 pole
0-30	20306	20308	60306	60308
31-60	20606	20608	60606	60608
61-100	21036	21038	61036	61038
101-200	22001	22003	62001	62003
201-400	24001	24003	64001	64003
401-600	2631	2633	6631	6633

A variety of pole configurations and termination provisions is available. Refer to the fuseholder section of this catalog for details.

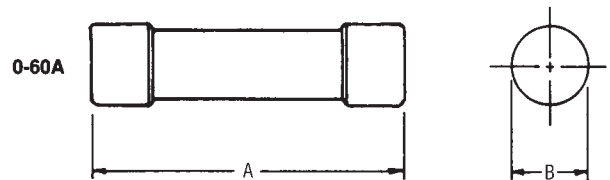

0-60A

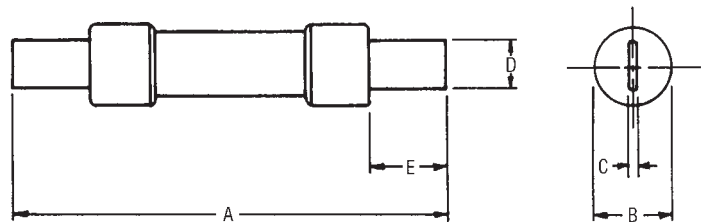

Dimensions

AMPERE RATING	A		B		C		D		E	
	In.	mm	In.	mm	In.	mm	In.	mm	In.	mm
250V-RF FUSES										
0-30	2	51	9/16	14	-	-	-	-	-	-
31-60	3	76	13/16	21	-	-	-	-	-	-
61-100	5-7/8	149	1-1/16	27	1/8	3	3/4	18	1	25
101-200	7-1/8	181	1-9/16	40	3/16	5	1-1/8	28	1-3/8	35
201-400	8-5/8	219	2-1/16	54	1/4	6	1-5/8	41	1-7/8	48
401-600	10-3/8	264	2-9/16	66	1/4	6	2	51	2-1/4	57
600V-RFS FUSES										
0-30	5	127	13/16	21	-	-	-	-	-	-
31-60	5-1/2	139	1-1/16	27	-	-	-	-	-	-
61-100	7-7/8	200	1-5/16	34	1/8	3	3/4	18	1	25
101-200	9-5/8	244	1-13/16	46	3/16	5	1-1/8	28	1-3/8	35
201-400	11-5/8	295	2-9/16	67	1/4	6	1-5/8	41	1-7/8	48
401-600	13-3/8	340	3-1/8	80	1/4	6	2	51	2-1/4	57